

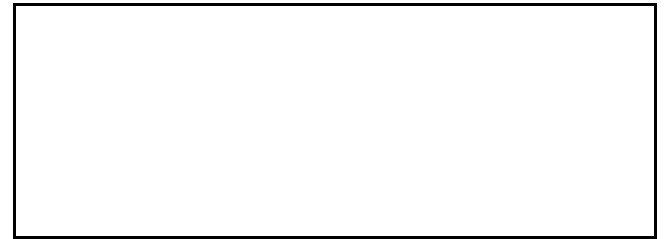

[Company]		[Name]		[Date]
[Address]		[Phone-No.]		Offer
[Code]	[City]	[Telefax-No.]		Order

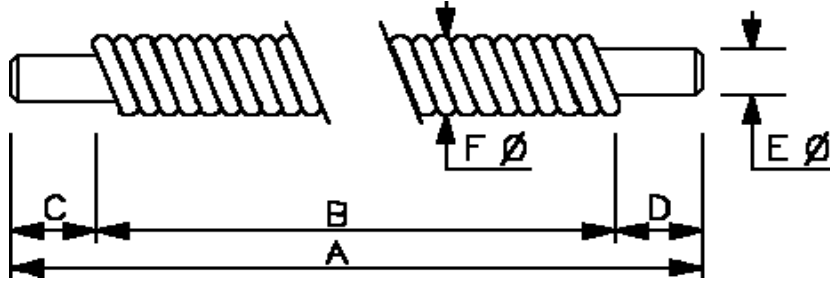

[Drawing for special Endingforms]

Item	Overall length	Wounded length	plain End	plain End	Bar Diameter	Overall Diameter	Winding Type	Wire Size	Quantity	chromed	polished	Bar Material	Wire Material	Bearing Type	Winding ends
	A	B	C	D	E	F								V C	P U
	[mm]	[mm]	[mm]	[mm]	[mm]	[mm]		[mm]	[pcs]						
01															
02															
03															
04															
05															
06															
07															
08															
09															
10															
11															
12															

Winding Types :

- LSB : Single Wound
- LCB : Compound Wound
- LTB : Tri Wound
- LPB : Plain Bar

Bar Bearing :



Winding Ends :

Do you want the wire securing area to stand proud (normal) **P**
 or to be undercut **U**

We want to thank you for filling out this data-sheet.
 Please send us the filled out form back by Fax or E-Mail.

Telefax - No. : +49-2293 - 309-199
E-Mail : info@petax.de

Notes
